

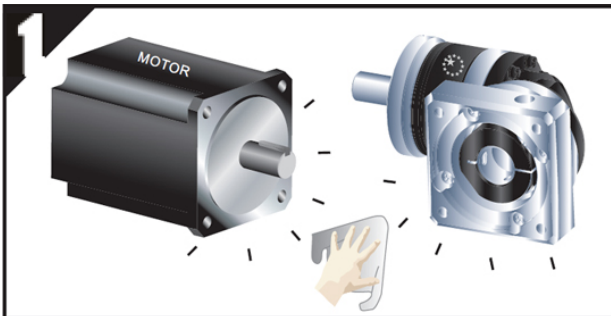

MOTOR MOUNTING INSTRUCTION

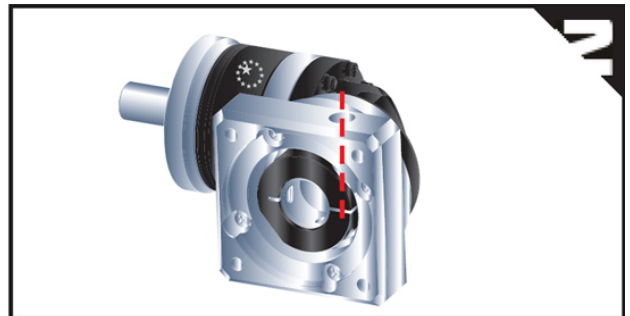

Double-check the motor and gearbox size
Clean the mounting surface



Rotate the set collar until the bolt is aligned with access hole.

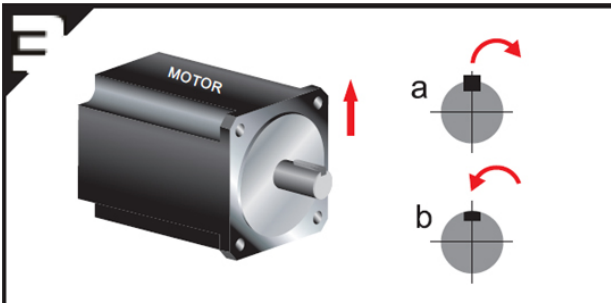

a Remove motor key, if necessary
b Insert balance key, if necessary

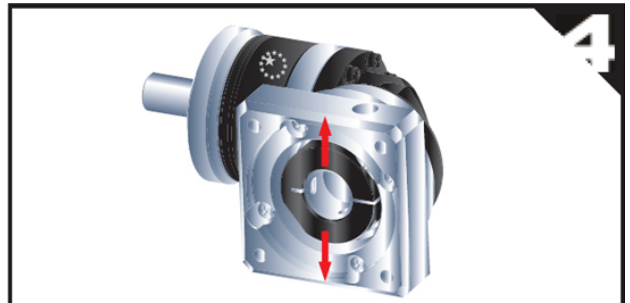

Check motor shaft size and insert bushing, if necessary

Correct Installation

When installing on keyed or flatted shafts, orient per figures below.

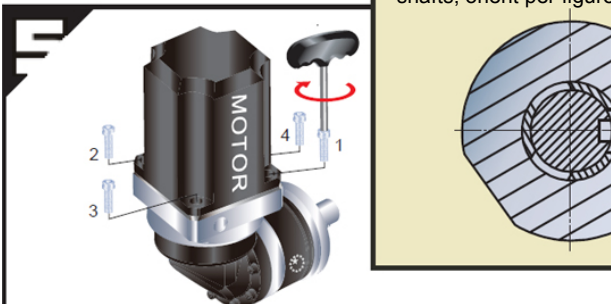

Set at vertical position, tighten the mounting bolts (including washer) in 1~4 order with wrench to 5% specified torque (see table 1)

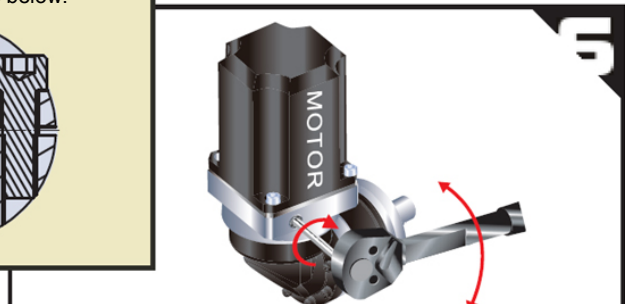

Tighten the set collar bolt with torque wrench to specified torque (see table 2)

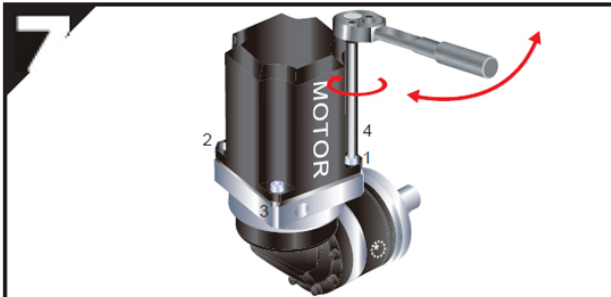

Tighten the mounting bolts in 1~4 order with torque wrench to specified torque (see table 1)

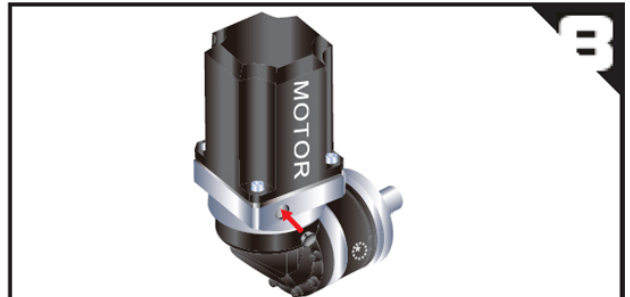

Insert the plug



MOTOR MOUNTING INSTRUCTION

Table 1 Tightening torque recommended for motor mounting bolt

Bolt size	Width Across Flats	Strength 8.8 Tightening Torque		Strength 10.9 Tightening Torque		Strength 12.9 Tightening Torque	
	[mm]	[Nm]	[In-lbs]	[Nm]	[In-lbs]	[Nm]	[In-lbs]
M3 x 0.5P	2.5	1.3	12	1.8	16	2.1	19
M4 x 0.7P	3	3	27	4.1	37	4.9	44
M5 x 0.8P	4	6.1	55	8.2	73	9.8	87
M6 x 1P	5	11	98	14	124	17	151
M8 x 1.25P	6	25	222	34	302	41	364
M10 x 1.5P	8	49	434	67	594	80	709
M12 x 1.75P	10	85	753	116	1028	139	1232
M14 x 2P	12	137	1214	186	1648	223	1976
M16 x 2P	14	210	1860	286	2534	343	3038

Table 2 Tightening torque recommended for set collar bolt

Gearbox size	Motor shaft diameter	Bolt Size	Width across flats	Tightening torque		
	[mm]	[mm]	[mm]	[Nm]	[In-lbs]	
PEIIR 050 PGIIR 040 PSIIR A	PAIIR 042 PDIIR 053	C3 ≤ 8	M5 x 0.8P x 16L	4	9,8	87
		C3 ≤ 11	M5 x 0.8P x 16L	4	9,8	87
		C3 ≤ 14	M5 x 0.8P x 16L	4	9,8	87
PEIIR 070 PGIIR 060 PSIIR B	PAIIR 060 PDIIR 064 PLIIR 070	C3 ≤ 8	M5 x 0.8P x 16L	4	9,8	87
		C3 ≤ 11	M5 x 0.8P x 16L	4	9,8	87
		C3 ≤ 14	M5 x 0.8P x 16L	4	9,8	87
		C3 ≤ 19	M8 x 1.25P x 25L	6	41	364
PEIIR 090 PGIIR 080 PSIIR C	PAIIR 090 PDIIR 090 PLIIR 090	C3 ≤ 14	M5 x 0.8P x 16L	4	9,8	87
		C3 ≤ 19	M8 x 1.25P x 25L	6	41	364
		C3 ≤ 24	M8 x 1.25P x 25L	6	41	364
		C3 ≤ 28	M8 x 1.25P x 25L	6	41	364
PEIIR 120 PGIIR 120 PSIIR D	PAIIR 115 PDIIR 110 PLRII 120	C3 ≤ 19	M8 x 1.25P x 25L	6	41	364
		C3 ≤ 24	M8 x 1.25P x 25L	6	41	364
		C3 ≤ 28	M8 x 1.25P x 25L	6	41	364
		C3 ≤ 32	M10 x 1.5P x 30L	8	80	709
		C3 ≤ 35	M10 x 1.5P x 30L	8	80	709
		C3 ≤ 38	M10 x 1.5P x 30L	8	80	709
PEIIR 155 PGIIR 160 PSIIR E	PAIIR 142	C3 ≤ 19	M8 x 1.25P x 25L	6	41	364
		C3 ≤ 24	M8 x 1.25P x 25L	6	41	364
		C3 ≤ 28	M8 x 1.25P x 25L	6	41	364
		C3 ≤ 32	M10 x 1.5P x 30L	8	80	709
		C3 ≤ 35	M10 x 1.5P x 30L	8	80	709
		C3 ≤ 38	M10 x 1.5P x 30L	8	80	709
		C3 ≤ 42	M12 x 1.75P x 35L	10	139	1232

Note: Tightening torque values can be exceeded by 20% for increased clamping force.

Apex Dynamics bv
Churchillaan 101
NL-5705 BK Helmond
The Netherlands

Tel. : +31 (0)492 509 995
Fax : +31 (0)492 509 997
E-mail : sales@apexdyna.nl

For more information, please visit our website: www.apexdyna.nl

High Precision Planetary Gearboxes